

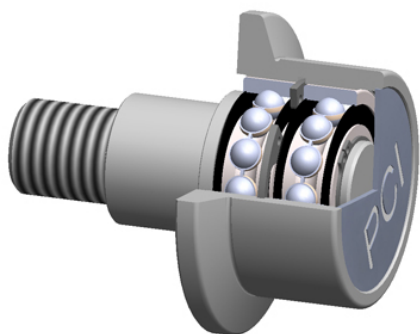

Sealmaster BEARING LTD



PCI Procal Inc. FTRE-1.125 Flanged Cam Followers

Bearing No. FTRE-1.125

roller diameter:	1.1250 in
roller material:	Chrome Steel
roller width:	0.7810 in
bearing element:	Balls - Two Rows
D	1.5000 in
roller shape:	Single Flanged
flange thickness:	0.2190 in
closure type:	Double Seal
stud diameter:	0.6250 in
radial dynamic load capacity:	627 lbs
thread size:	7/16-20
radial static load capacity:	278 lbs
stud length:	1.5000 in
technical specifications:	Click here

FTRE-1.125 Bearing 2D drawings and 3D CAD models